



POWERED by  
**LONCIN**



MOTORE 4 TEMPI - ENGINE 4 STROKE

Modello Model	Potenza nominale Rated power	Coppia massima Max. torque		Sistema avviamento Starting system	Cilindrata Displacement	Carburante Fuel
type	3600 r.p.m.	Nm	rpm	type	cc	type
Monocilindrico, raffreddamento ad aria, 4 - tempi Single cylinder, forced air cooling, 4 - stroke	1,7 kW	4	3000	manuale recoil	80	<b>Benzina Gasoline</b>

Capacità serbatoio Tank capacity	Capacità serbatoio olio Oil tank capacity	Rumorosità Noise	Alesaggio corsa Bore Stroke	Dimensioni Dimensions	Peso a secco Dry weight
lt	lt	≤7m dB (A)	mm	mm	Kg
1,4	0,35	70	48 x 43	255 x 330 x 335	8

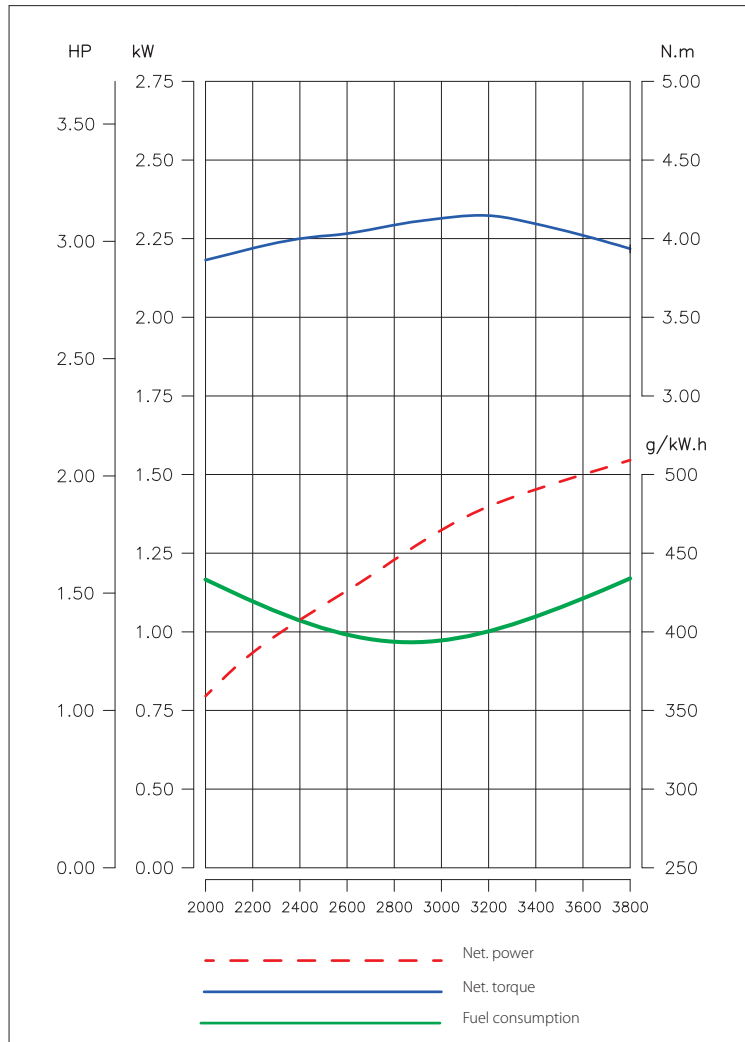

## VERSIONE / VERSIONS



Albero cilindrico D.15  
Cilindric - shaft

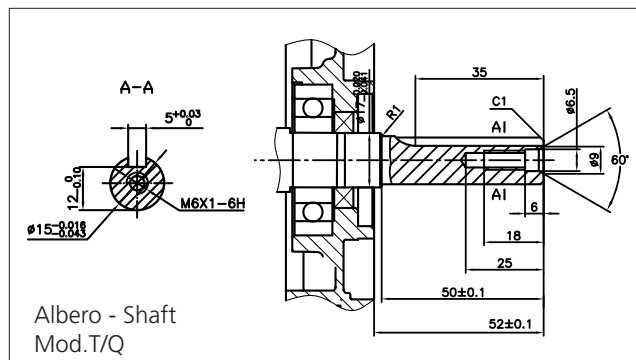

## G 148 F-T/Q

- Albero Cilindrico D.15
- Avviamento Manuale
- Filtro aria a secco